

# EMRB Municipal Data Sheet

13-member municipalities  
3 towns, 4 counties, 6 cities



 37,645

 37.5 km<sup>2</sup>

(CANADIAN CENSUS, 2021)

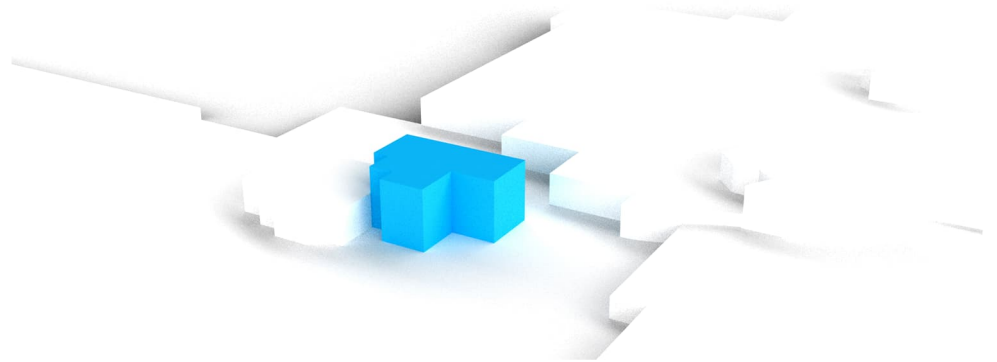

## Highlights

Spruce Grove, a city located roughly 11 km west of the provincial capital, boasts a mix of industry, commerce, community, and education (including a satellite campus of the Northern Alberta Institute of Technology, NAIT).

The City of Spruce Grove provides the comfort of a small-town community, while offering the amenities of city living. These amenities include a wide range of shops and restaurants. There are also plenty of recreation and leisure options, with over 40 km of all-weather trails that connect many of the City's neighbourhoods, playgrounds, and parks.

“ The best place in the Tri-Region to live and raise a family. ”

JEFF ACKER | MAYOR



## TAX BASE—ASSESSMENT

Residential	\$5.7B
Non-Residential	\$1.2B

Spruce Grove's total municipal operating budget is \$86 million with a capital budget of \$46 million.

The City's assessment base is primarily residential (83%), followed by commercial and industrial (17%).

## ABOUT US

The City of Spruce Grove is a major commercial and industrial player in the Region.

It is also one of the fastest growing communities in Canada, with an average annual growth rate of 3.4% over the last 10 years.

Spruce Grove also has a strong focus on families, community, and social wellbeing.



## REGIONAL AREAS OF FOCUS

- Undertaking a five-year interim review of the EMRB's growth plan and ensuring there is a successful and robust regional transit network.
- The City is also eager to explore opportunities for inter-municipal cost- and revenue-sharing, and partnerships.

## LOCAL STRATEGIC PRIORITIES

The City of Spruce Grove's strategic priorities are:

- Updating its Municipal Development Plan.
- Attracting commercial and industrial investment and expanding local employment opportunities.
- Ensuring fiscal sustainability through the use of reserves and managing municipal debt levels.

# Stats & Facts

(CANADIAN CENSUS, 2021)



## Commute

→ 63% commute for work outside municipality



## Housing

→ 76% own their own homes



## Employment

→ 63% employment rate with 70% participation rate



## Work Force

(top 2 occupation sectors)

- 27% trades, transportation, equipment operators, etc.
- 25% sales and service



## Education

→ 51% completed post-secondary education



## DEMOGRAPHICS

The City of Spruce Grove's population has increased over 10% since the 2016 federal Census.

The average age is 37 years, with just over 78% of the population being 15 years and older.

Just over 12% of the population is 65 years and older.

Visible minorities account for roughly 10% of the municipality's total population, and Indigenous and immigrant populations are both just over 18%.



## SETTING IDEAS IN MOTION

The City of Spruce Grove is a fast-growing, dynamic city, committed to building and maintaining a fiscally responsible community that serves residents, attracts visitors, and promotes future growth.

The City carefully guides development and land use so as to ensure functionality and sustainability.

The City is a proven industrial player in the Region. It is close to road, rail, and air, and property taxes are affordable.

## Turning Challenges into Opportunities



*With the rapid pace of residential growth that the City is experiencing, there are added pressures including:*

- Providing additional services and amenities.
- A shortage of serviced industrial land, with limited opportunity for outward growth due to physical constraints (highway, natural areas).
- Realizing the challenges associated with lack of financial capacity to front-end growth.

### CURRENT CHALLENGES / INVESTMENT NEEDS:

- CN Rail tracks divide the community between north and south, and create challenges in accessing and developing south of the tracks.
- Significant investment into new infrastructure to service growth.
- Support for affordable housing and other social needs.
- Buildout of Highway 628.

### GREATEST RISKS FACING SPRUCE GROVE:

- Need for long-term, predictable funding by the Province.
- Sustained and increased proportion of non-residential assessment.
- Climate change and resilience response.

## Untapped Opportunities

- Revitalization of the city centre and older neighborhoods.
- New technology and smart city applications enabled by fibre-optic network.
- Development of existing and annexed lands for residential and industrial use.